

Transfer Media Compatibility Test Procedure

Warning: Conducting the suggested Compatibility Test may cause serious Paper Jams and Contamination and will require great care when removing the jammed Paper and/or the Contamination. If you do not feel confident you will be able to handle such incidents you should not conduct the Test. TheMagicTouch expressly rejects responsibility for any and all direct and/or indirect damages resulting from conducting the suggested Test.

The most likely Media/Paper Selection for your Printer/Copier would be as follows:

TTC3.1/CPM6.1 = Plain Paper or Thick/Heavy

OBM 5.5 = Thick/Heavy/XtraHeavy

TTC3.3/CPM6.3 = Plain Paper

DCT4.5/4.6 = Plain Paper/Thick/Heavy

WoW 7.1 Pro = Plain Paper

To determine whether or not your Copier/Printer would be compatible to process TheMagicTouch Transfer Media and which would be the appropriate Media/Paper Selection for the different Media follow the suggested procedures. Note: Before you start make sure you determine which side of the Media will be printed and feed the proper side up or down. You also might want to copy/print a Plain Paper as a reference for comparison.

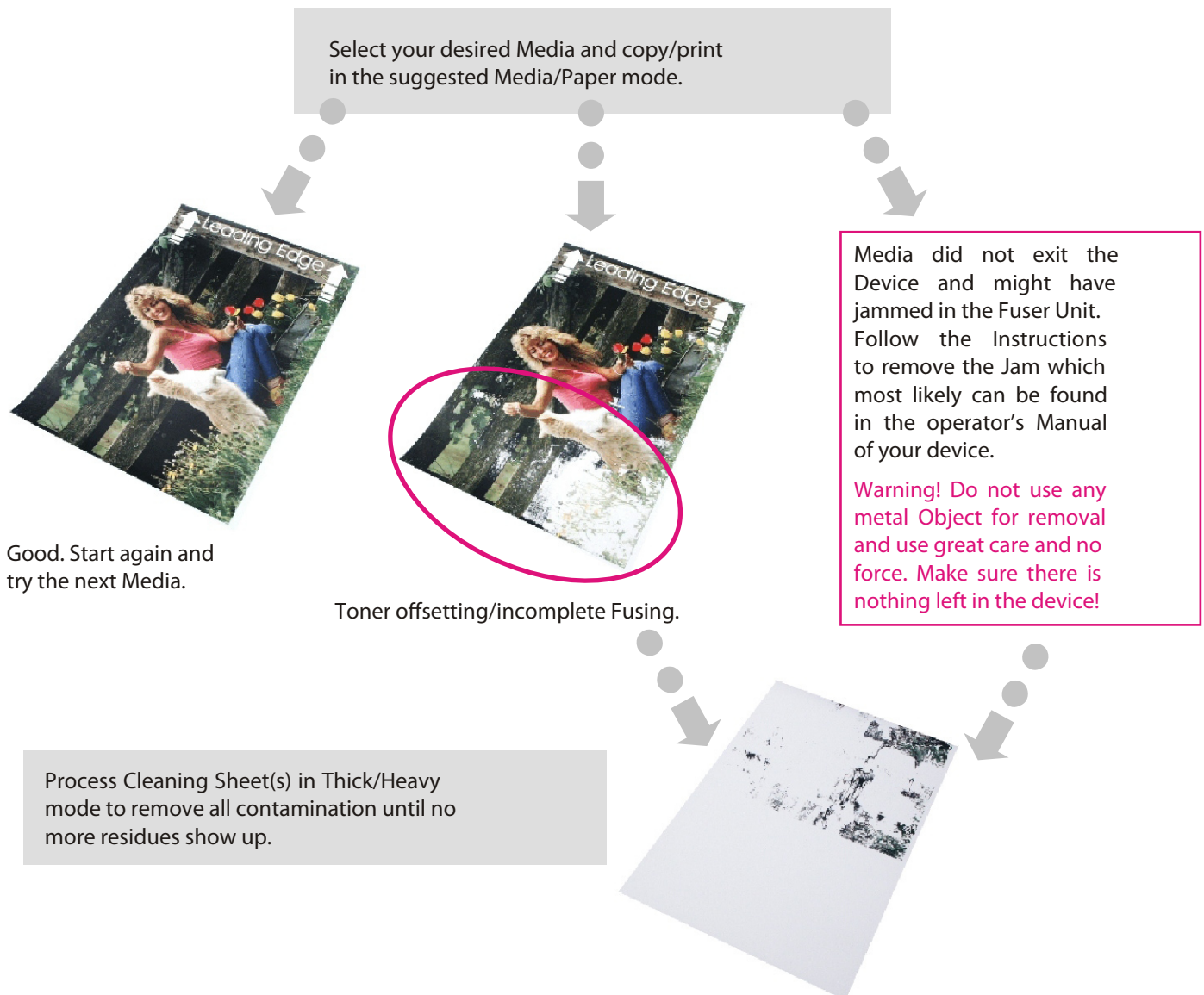

If your first choice Media did not fuse properly and the Toner has been offsetting you have two next options: One, use a lighter weight Media in the same Media/Paper mode, two, a heavier weight Media in a Thicker/Heavier mode. The same would apply in case of a Fuser Jam with one exception: If your first choice was the heaviest weight Media processed in Plain Paper mode there would not be much of an option left. For future Compatibility Up-Dates please visit our WebSite www.themagictouchusa.com/support